

# SLIDING WATERTIGHT DOOR, HI-SKD-YACHT-WT-1 PNEUMATIC OR ELECTRIC OPERATED

**Approval:** MCA Code of Practice for Safety of Large Commercial Sailing and Motor Vessels, up to 80 m Load Line Length  
**Watertightness:** 4 meters water column from either side.  
**Fire class:** A60

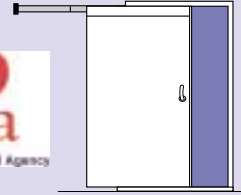

## STANDARD SPECIFICATION

**Doorleaf:** 54 mm thick, 2 mm steel skins, insulation core. Incl. front edge safety strip.

**Frame:** 3 mm pressed profile, welded to the bulkhead. Complete with track, swing trolleys, brackets and steering guides.

**Sill:** 3 mm pressed profile.

**Seal arrangement:** Adjustable seal holder with chloroprene rubber seal.

**Finish:** Door leaf and frame galvanized and primed.

**Hardware:** Locking arrangement and emergency opening device.

**Power operation:** Pneumatic or electric controls.

**Max. size:** 1400 mm width.

**Weight:** Doorleaf and frame  $\approx$  160 kg/m<sup>2</sup>, excluding pneumatic or electric controls.

**Safety features:** Door front edge safety strip. Reserve air reservoirs/back up batteries. Emergency opening device.

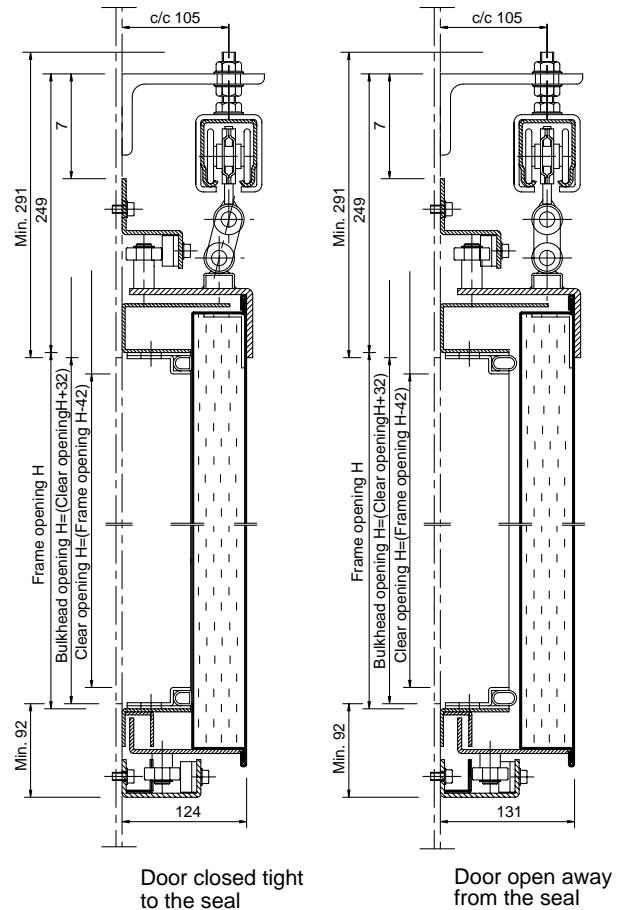

Door closed tight to the seal

Door open away from the seal

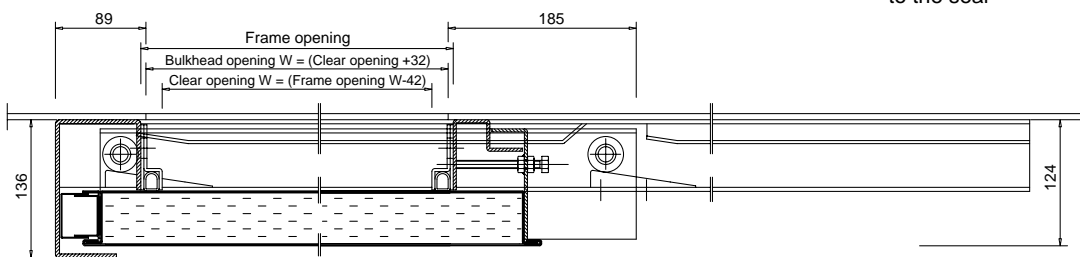

Door closed tight to the seal

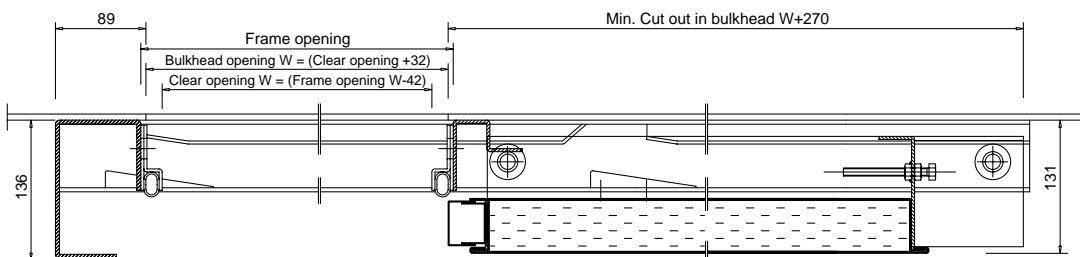

Door open away from the seal

### SPECIAL FACTS

**Optional features:** Data sheet MOAS

**Pneumatic control:** Data sheet MP1

**Electric control:** Data sheet ME1