

HINGED DOUBLE REBATED DOOR HI-BDD-F79-2

A60 fire class
Tested to IMO 754(18)
FTP code part 3

EC Type-Examination Certified
CE Marked

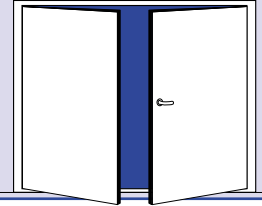

STANDARD SPECIFICATION:

Doorleaf: 43-54 mm thick, 1,0 - 1,5 mm galvanized steel skins, insulation core, preparation for modular latch and automatic flush bolts, reinforced for overhead doorcloser on pull side.

Frame: 3 mm Z profile in galvanized steel, as standard welded to bulkhead.

Sill: Inverted U-profile as alt. 3 in stainless steel.

Hoseport hatch: On request.

Finish: Primed.

Hardware: 2 or 3 adjustable hinges, latch, lever handle, door closer, automatic flush bolts in non active door leaf and door selector/co-ordinator.

Max. size: 2300 x 2240 mm, WxH

Weight: Doorleaf ≈ 35 kg/m²
Doorleaf and frame ≈ 45 kg/m²

Sound reduction: Standard version 38 dB Rw
Acoustic version 43 dB Rw

Single leaf door: Data sheet MAH3

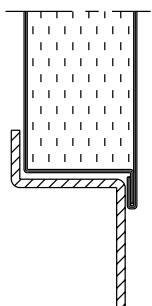
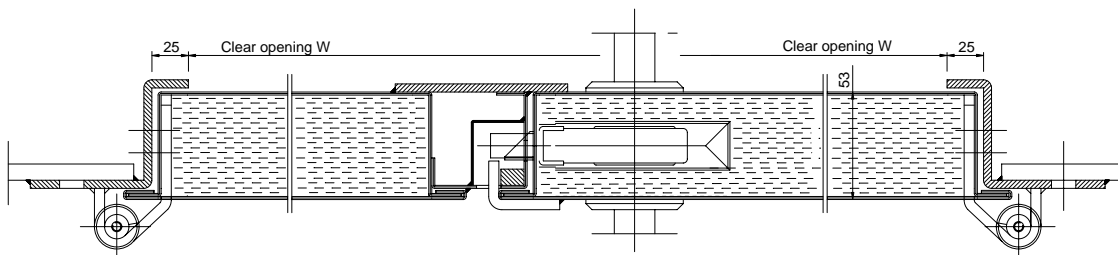
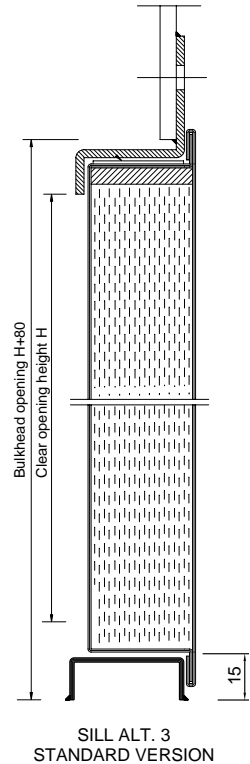

SILL ALT. 1

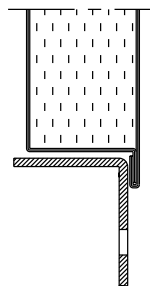

SILL ALT. 2

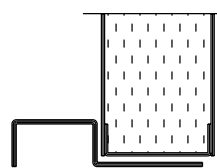

SILL ALT. 4

SPECIAL FACTS
Optional features: Data sheet MOAH